

**SmartBright Solar Lowbay**  
BY010P Mounting instruction

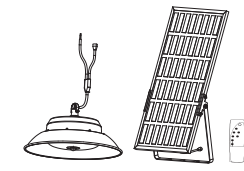

Type Number	Flux(lm)	Battery type	Battery parameter	PV parameter	Remote type	Sensor type	CCT	Working temperature	Weight
BY010P LED16/730 Solar	1600lm	Lithium iron phosphate	12.8V/3.3Ah	15W/15V	Infrared	Infrared	3000K	0-50°C	2.33Kg
BY010P LED16/740 Solar									
BY010P LED16/765 Solar									
BY010P LED36/730 Solar	3600lm	Lithium iron phosphate	9.6V/9.9Ah	32W/15V	Infrared	Infrared	3000K	0-50°C	4.37Kg
BY010P LED36/740 Solar									
BY010P LED36/765 Solar									

Unic: mm						
TYPE	D	L	LI	L2	H	
1600lm	273	450	300	150	155	
3600lm	344	450	300	150	170	

TYPE	W1	L3	L4	d	axb	HI	LS
1600lm	350	350	180	8.5	15x8.5	15	4800
3600lm	350	680	180	8.5	15x8.5	15	4800

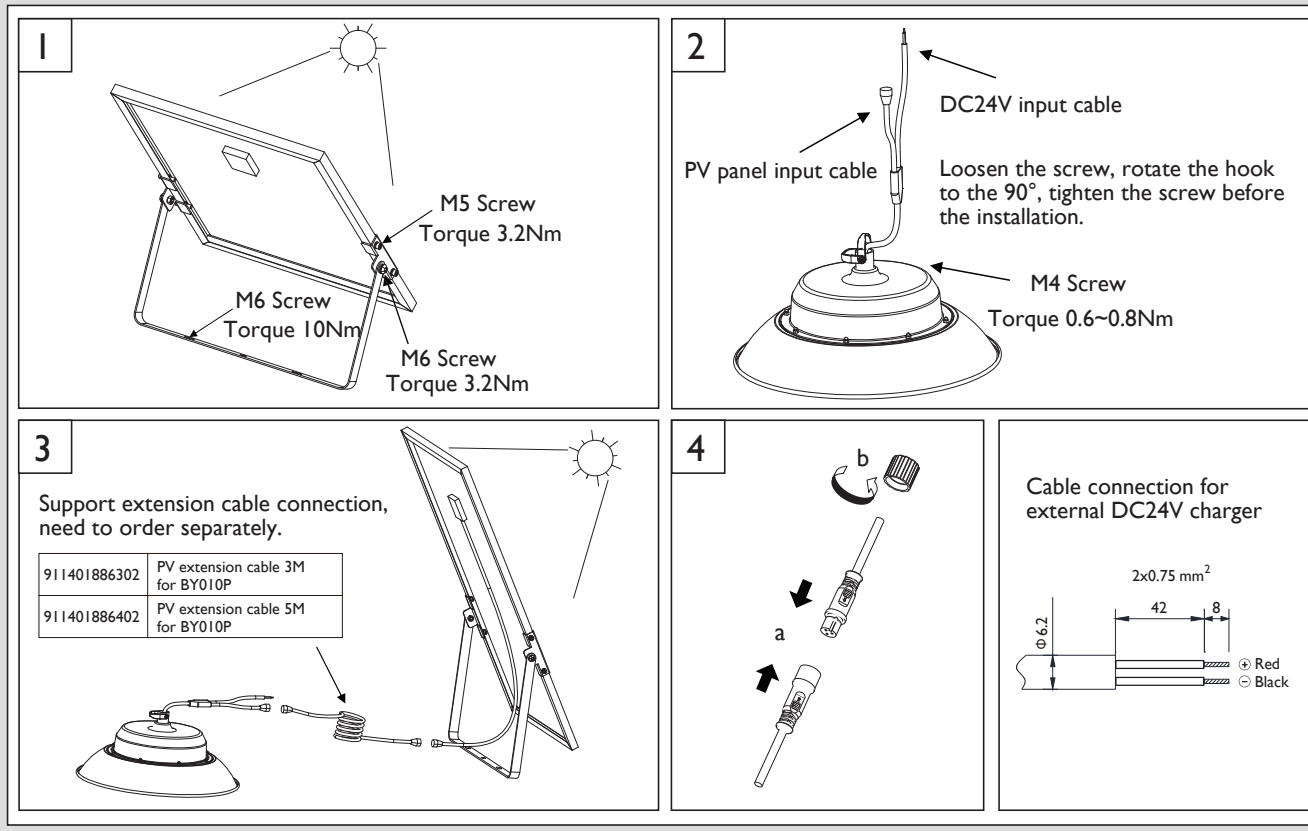

SONY LUMINAIRE (SHANGHAI) CO., LTD.  
Address: 2F, Building 1, No. 2555 Hechuan Road, Minhang District, Shanghai, P.R. China  
Postal code: 201313  
销售热线 (上海): 400900000  
上海销售地址: 四川路2005号1楼二楼  
邮编: 200233



Philips and the Philips shield emblem are registered trademarks of Koninklijke Philips N.V.

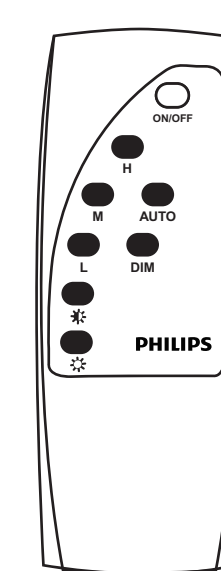

**ON/OFF:** Wake-up (ON)/Sleep (OFF), the luminaire turns on and keep the same working mode as last mode setting.  
**AUTO:** Automatic Sensor Dimming Mode, the luminaire automatically turns on as PV panel detects the sunset. (Same as Mode M setting).  
**H:** The luminaire automatically turns ON at 30% brightness as PV panel detects the sunset. If someone is detected, the brightness will be increased to 100% for 15 seconds. Turns off at battery low.  
**M:** The luminaire automatically turns ON at 20% brightness as PV panel detects the sunset. If someone is detected, the brightness will be increased to 100% for 15 seconds. Turns off at battery low.  
**L:** The luminaire automatically turns ON at 10% brightness as PV panel detects the sunset. If someone is detected, the brightness will be increased to 100% for 15 seconds. Turns off at battery low.  
**DIM:** Time Control Dimming Mode, the luminaire automatically turns ON as PV panel detects the sunset, and the luminaire will keep running according to the time control dimming setting (20% brightness output in first 1 hour, 100% brightness output in 0.5 hour, 40% brightness output in 1 hour, 20% brightness output in 1.5 hour, 10% brightness output in 2 hours, 5% brightness output in 6 hours). Turns off at battery low. (The sensor function is disabled in DIM-mode, and the lighting time is up to 12hours in the state of the full charged battery)  
\* Constant lighting mode: Decrease the brightness every 10% each time by pressing this button, and the minimum brightness can keep 10%. (The light sensor and PIR sensor and time control function are all disabled in this mode)  
\* Constant lighting mode: Increase the brightness every 10% each time by pressing this button, and the maximum brightness can keep 100%. (The light sensor and PIR sensor and time control function are all disabled in this mode)

- Notes:**
- The setting default of this luminaire is AUTO: Automatic Sensor Dimming Mode.
  - Press the or button to turn on the constant lighting mode at day time or at night time.
  - In constant lighting mode, the luminaire turns off at battery low. And the luminaire will return to the dimming mode with memory function after the battery power recharged.
  - In constant lighting mode, the light sensor and PIR sensor and time control function are all disabled in this mode. And the luminaire will keep working at the setting brightness. Turns off at battery low.
  - LED indication on luminaire: solid red light (the state of charging), flashing red light (low battery capacity).

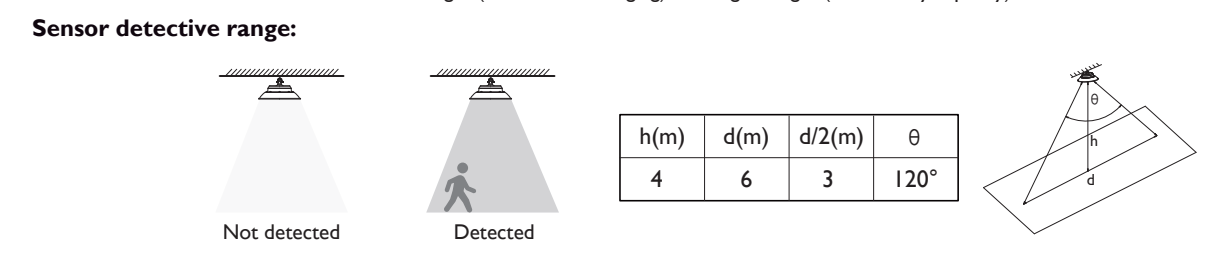

- Application NOTES:**
- Install the solar panel on open roof or wall facing towards Sun. The tilt angle can be adjusted.
  - There shall not be any light source over the solar panel at night, as it may interfere with the operations of the luminaire.
  - Charge the battery under Sunlight at least 8 hours before first use.
  - After installation, the working modes can be set by the infrared remote controller.
  - This luminaire works 100% on solar energy, and it also can be charged via the external DC24V charger. The charging power for 1600lm one must be higher than 20Watt, the charging power for 3600lm one must be higher than 35Watt. The voltage range for external DC24V charger can be DC22-26V. (In case wrong DC charger is used not matching mentioned specification, the product may get damaged and the warranty will be void.)
  - Detection of dark/dawn is based on lighting intensity falling on solar panel.
  - The battery capacity will be reduced when the ambient temperature is below zero degree Celsius.
  - When the battery low capacity (<30%), the brightness output will be dimmed to 15% brightness to extend the running time, and the luminaire turns off at battery low.
  - This product contains lithium batteries, it is important to note that if the battery is not used for a long period of time (>11 months), it may be in some state of over-discharge due to its self-discharge characteristics. Over-discharge may degrade battery performance, and the warranty shall be void.
  - Applications: Under Canopy/Backyard/Parking Shed/Warehouse/Amenity Not to use in outdoor areas.
  - The light source and/or control gear and/or external flexible cable contained in this luminaire are not replaceable, in case of damage, please replace the luminaire.
  - Please inform yourself about the local waste disposal, separation and collection system for electrical and electronic products and packaging. Please act according to your local rules and do not dispose your old product and packaging with your normal household waste. The correct disposal of the packaging, your product and/or batteries will help prevent potential negative consequences for the environment and human health. Batteries should be disposed separately from the municipal waste stream via designated collection facilities. When disposing a product that contains non-user replaceable batteries, the non-user replaceable batteries shall be removed by a professional.

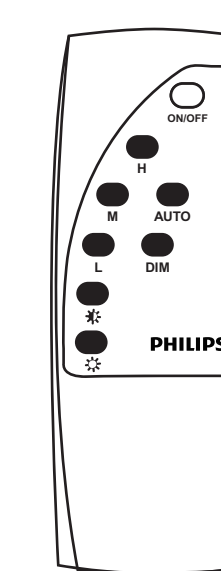

**ON/OFF:** 唤醒 (ON) / 睡眠 (OFF) 在白天使用本产品时，太阳能电池板检测到日落时，本产品会自动开启。  
**AUTO:** 自动传感器调光模式，本产品会在太阳能电池板检测到日落时自动开启。（与模式 M 设置相同）。  
**H:** 本产品会在太阳能电池板检测到日落时自动开启，亮度为 30%。如果有人检测到，亮度将增加到 100%，持续 15 秒。在电池电量低时关闭。  
**M:** 本产品会在太阳能电池板检测到日落时自动开启，亮度为 20%。如果有人检测到，亮度将增加到 100%，持续 15 秒。在电池电量低时关闭。  
**L:** 本产品会在太阳能电池板检测到日落时自动开启，亮度为 10%。如果有人检测到，亮度将增加到 100%，持续 15 秒。在电池电量低时关闭。  
**DIM:** 时间控制调光模式，本产品会在太阳能电池板检测到日落时自动开启，并根据时间控制调光设置（第一个小时亮度输出为 20%，0.5 小时内亮度输出为 100%，第一个小时亮度输出为 40%，1.5 小时内亮度输出为 20%，2 小时内亮度输出为 10%，6 小时内亮度输出为 5%）。在电池电量低时关闭。（传感器功能在 DIM 模式下禁用，且照明时间最长可达 12 小时（完全充满电的电池状态下））。  
\* 恒定照明模式：每次按下此按钮，亮度将降低 10%，且最低亮度可保持 10%。（光传感器、PIR 传感器和时间控制功能在此模式下均禁用）。  
\* 恒定照明模式：每次按下此按钮，亮度将增加 10%，且最高亮度可保持 100%。（光传感器、PIR 传感器和时间控制功能在此模式下均禁用）。

- Notes:**
- 产品的默认设置为 AUTO: 自动传感器调光模式。
  - 按下 或 按钮，可在白天或夜间开启恒定照明模式。
  - 在恒定照明模式下，产品在电量耗尽时会自动关闭。充电后，产品将恢复到带记忆功能的调光模式。
  - 在恒定照明模式下，光传感器、PIR 传感器和时间控制功能均被禁用。在此模式下，产品将在设定的亮度下持续工作。在电量耗尽时关闭。
  - LED 指示灯在灯具上：常亮红灯（充电状态），闪烁红灯（低电量容量）。

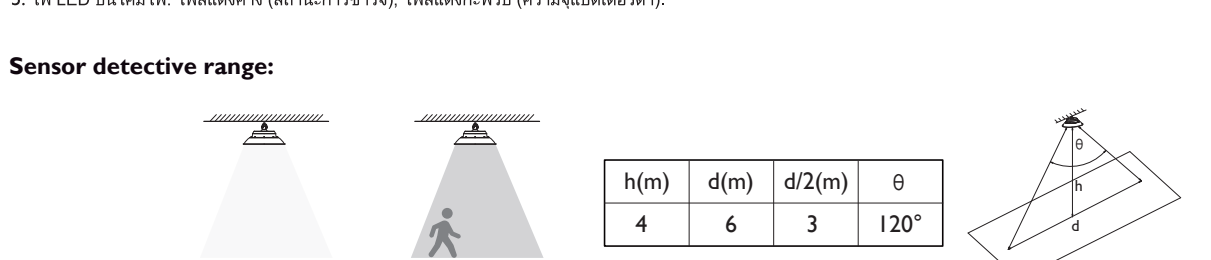

- Application NOTES:**
- 将太阳能电池板安装在面向太阳的开放屋顶或墙壁上。倾斜角度可调整。
  - 夜间太阳能电池板上不得有任何光源，以免干扰产品的操作。
  - 首次使用前，请在阳光下充电至少 8 小时。
  - 安装后，可通过红外遥控器设置工作模式。
  - 本产品 100% 依靠太阳能工作，也可通过外部 DC24V 充电器充电。1600lm 型号的充电功率必须高于 20W，3600lm 型号的充电功率必须高于 35W。外部 DC24V 充电器的电压范围应为 DC22-26V。（如果使用不符合规格的 DC 充电器，可能会导致产品损坏且保修无效。）
  - 暗/黎明检测基于照射在太阳能电池板上的光照强度。
  - 当环境温度低于零摄氏度时，电池容量会降低。
  - 当电池容量低（<30%）时，亮度输出将调低至 15% 以延长运行时间，并在电池电量耗尽时关闭产品。
  - 本产品含有锂电池，请注意，如果电池长时间（>11 个月）不使用，可能会处于过放电状态。过放电可能会降低电池性能，且保修无效。
  - 应用：车棚/后院/停车场/车棚/仓库/便民亭。请勿在户外使用。
  - 本产品的光源、控制元件和/或外部柔性电缆不可更换。如有损坏，请更换整个灯具。
  - 请了解当地的废物处理、分离和收集系统，适用于电气和电子产品及其包装。请根据您的当地规定行事，切勿将旧产品或包装与您的普通生活垃圾一起处理。正确处理包装、您的产品和/或电池将有助于防止对环境或人类健康产生潜在的负面影响。电池应通过指定的收集设施，从城市垃圾流中单独处理。当处理含有不可更换电池的电子产品时，不可更换的电池应由专业人员移除。