



UNIBollard

BCP311 LED760/WW 15W 100-240V Cyl BK

UNIBollard, 760 lm, 15 W, 830 warm white, Safety class I, Baseplate

UNIBollard is dedicated to light up public environments of park, buildings outside area, compound areas to bring you a more bright light in evening with the safety and convenience. Its graceful appearance is also a part of public scenery to beautify area you live.

Warnings and Safety

- Use additional surge protection device in electrical circuit for lighting wiring.

Product data

General Information	
Light source replaceable	No
Driver included	Yes
Light source engine type	LED
CE mark	-
Flammability mark	-
Light Technical	
Luminous Flux	760 lm
Standard tilt angle posttop	-
Correlated Color Temperature (Nom)	3000 K
Luminous Efficacy (rated) (Nom)	40 lm/W
Color rendering index (CRI)	>80
Light source color	830 warm white
Optical cover type	Polycarbonate bowl/cover frosted

Operating and Electrical	
Input Voltage	100 to 240 V
Line Frequency	50 or 60 Hz
Power Consumption	15 W
Power Factor (Fraction)	0.9
Connection	Screw connection block 3-pole
Cable	Cable 0.3 m with connector 3-pole
Temperature	
Ambient temperature range	-40 to +50 °C
Controls and Dimming	
Dimmable	No
Control interface	-

Mechanical and Housing

Housing Material	Aluminum
Optic material	Polycarbonate
Optical cover material	Polycarbonate
Housing Color	Black and aluminum
Mounting device	Baseplate
Optical cover finish	Frosted
Overall height	600 mm
Overall diameter	160 mm

Approval and Application

Ingress protection code	IP65 [Dust penetration-protected, jet-proof]
Mech. impact protection code	IK06 [1 J]
Protection class IEC	Safety class I

Initial Performance (IEC Compliant)

Luminous flux tolerance	+/-10%
Power consumption tolerance	+/-10%

Product Data

Order product name	BCP311 LED760/WW 15W 100-240V Cyl BK
Full product name	BCP311 LED760/WW 15W 100-240V Cyl BK
Full product code	911401755272
Order code	911401755272
Material Nr. (12NC)	911401755272
Numerator - Quantity Per Pack	1
Numerator - Packs per outer box	4

Dimensional drawing

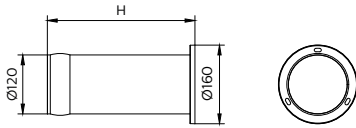

	H:mm
BCP310	300
BCP311	600
BCP312	1200

